

Designer
Aquib Khan



Project Name SERENE SLUMBER

A calm and peaceful atmosphere
that's conducive to restful sleep

01	Client Brief	03
02	Needs & Requirements	04
03	Functional & Emotional Needs	05
04	Floor Plan	06
05	Layouts	07-10
06	Moodboards	11-12
07	Colors	13-15
08	Lights	16-17

09	Materials & Finishes	18-21
10	Furniture & Furnishing	22-24
11	Renders	25-28
12	Elevations	29
13	Procurement Data	30-32
14	Callout	33
15	Client Brief & Development	34

CLIENT BRIEF



Name & Age

Omer (32) & Sadiya (26)

Type

Residential (2 Flats of 1 BHK combined to make it 3 BHK)

People who lives in the House

- The Couple (3 Kids)
 - Hamdan (6 Years)
 - Farah (5 Years)
 - Haaniya (2 Months)
- Elder Brother & his Wife (4 Kids)
- Mother
- Cousin Brother

Space to Design / Area

Bedroom & Bathroom / 110 sq.ft

People who visit the House

Maid & Guests

Location

Flat No. 603/604, Navi Mumbai

Background

Omer Fakhri is a Travel agent working with his elder brother in their own business named Pacific Tours and Travels. They love to travel. They also love having their extended family members over regularly. He spends most of his time in the office except on weekends. On weekends, he likes to spend time with his family at home. He is tech-savvy and would prefer everything to be at his fingertip.

Mrs. Sadiya Hurzuk is a homemaker carrying out her daily household chores. In the bedroom, she feeds & takes care of her children. She spends most of her time in the kitchen after her 6 & 5 years children leave for school. After they are back from school, they spend most of their time studying and playing in the living room with their siblings. Out of 3, the 2 elder children sleep in the living room and the infant in the bedroom. Sadiya likes light colors. She doesn't want television in the Room.

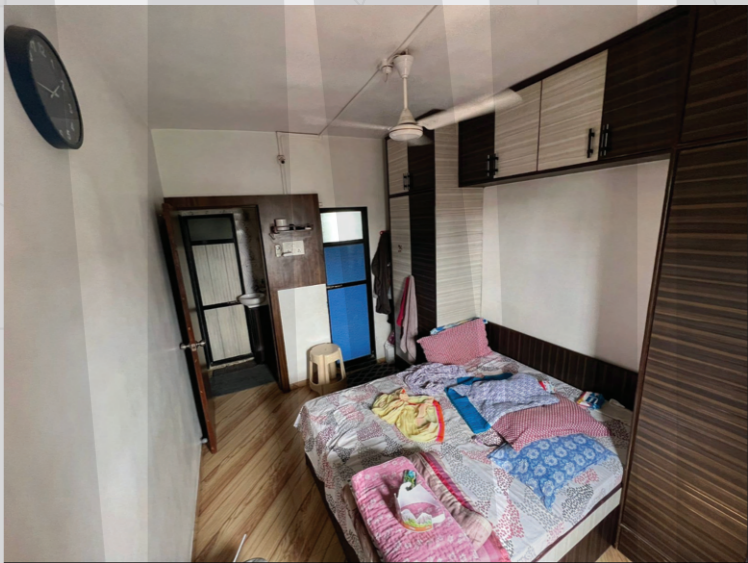

PHOTOS

NEEDS & REQUIREMENTS

Bedroom

- Bed with storage
 - Closet/Wardrobe & Mirror
 - Negative space for prayer
 - Curtains & Drapes to control afternoon sunlight
 - Ambient Lights
 - Fan & AC
 - Light colors on walls. Preferably Beige
 - Extra space for storage (Kids clothes)
 - Normal Tiles for flooring
 - Side table to keep mobiles & other stuff.
- Don't mind simple Wall arts
 - Plain, simple ceiling.
 - Space should feel intimate & cozy
 - Can have baby cot for 2 months old if possible in the given space.
 - No Television in the room

Style Preference

- Japandi Interior Style

Bathroom

- WC (Dry Area)
- Basin (Dry Area)
- Shower area (Wet Area)
- Mirror
- Storage to keep toiletries
- Clothes Hanger
- Geyser

FUNCTIONAL & EMOTIONAL NEEDS

Functional

- Bed with storage if possible
- Closet/Wardrobe & Mirror
- Curtains / Drapes to control afternoon sunlight
- Ambient Lights
- Normal Tiles for Flooring
- Side table to keep mobiles & other stuff
- Baby cot for 2 months old if possible
- Additional storage for kids clothes

Emotional

- Negative space for prayer
- Feeding and spending time with kids
- (Japandi Interior) Beige color for a peaceful, warm and cozy space.
- Mood Lightings for soothing ambience

FLOOR PLAN

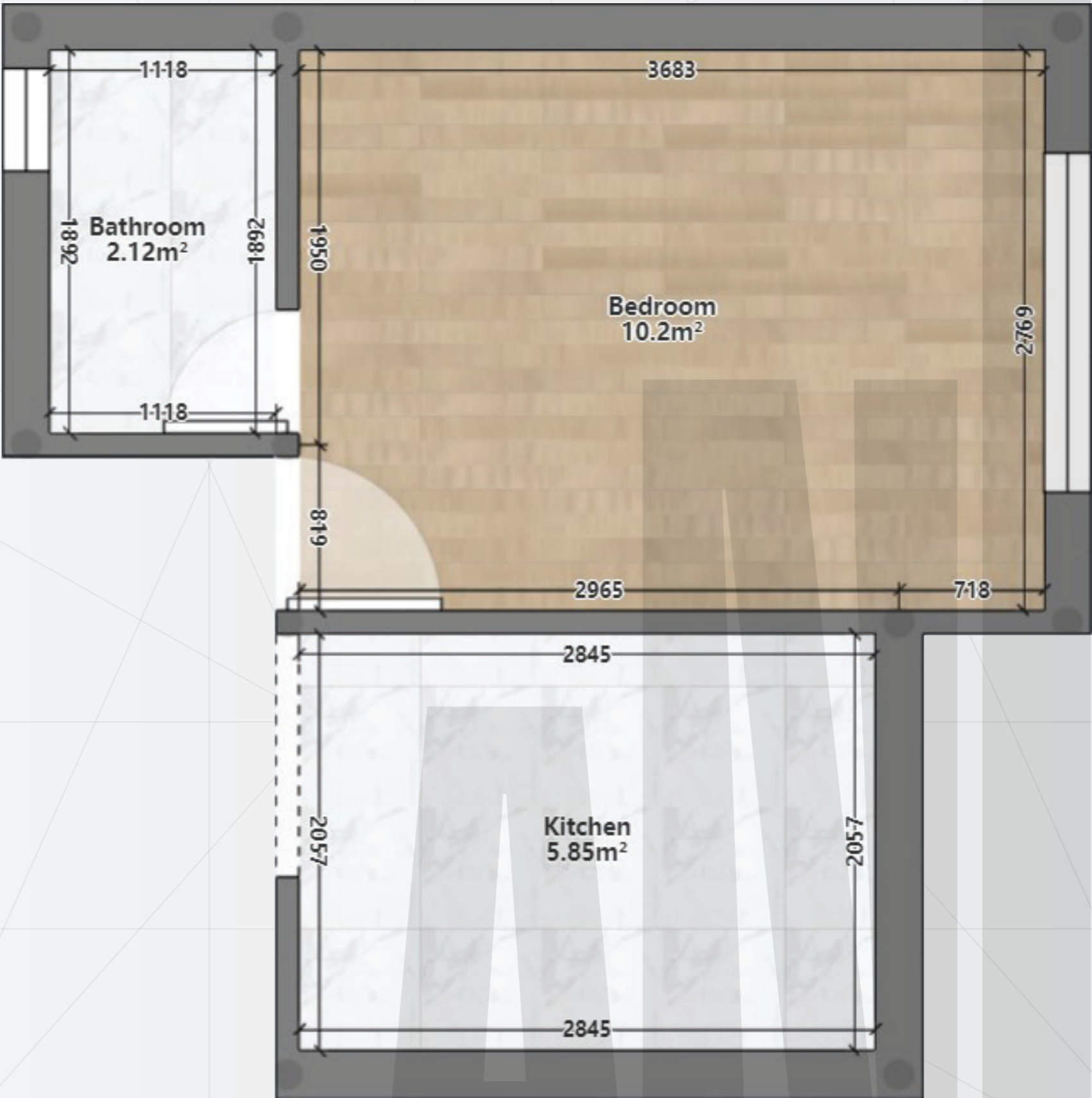

LAYOUT - 1

✓ Approved

SWOT Analysis

Strength

- Privacy is maintained when the door is kept opened as the bed isn't visible from the living room
- Afternoon sunlight will not hit directly on the face of the user while sleeping.
- Enough daylight.

Weakness

- Minimum negative space for circulation when the sofa bed is extended
- Only one side table can be included due to space constraint

Opportunities

- Sofa bed allows enough negative space for circulation & perform prayer

Threats

- It will be difficult for the person sleeping left side of the bed to go to bathroom at night.

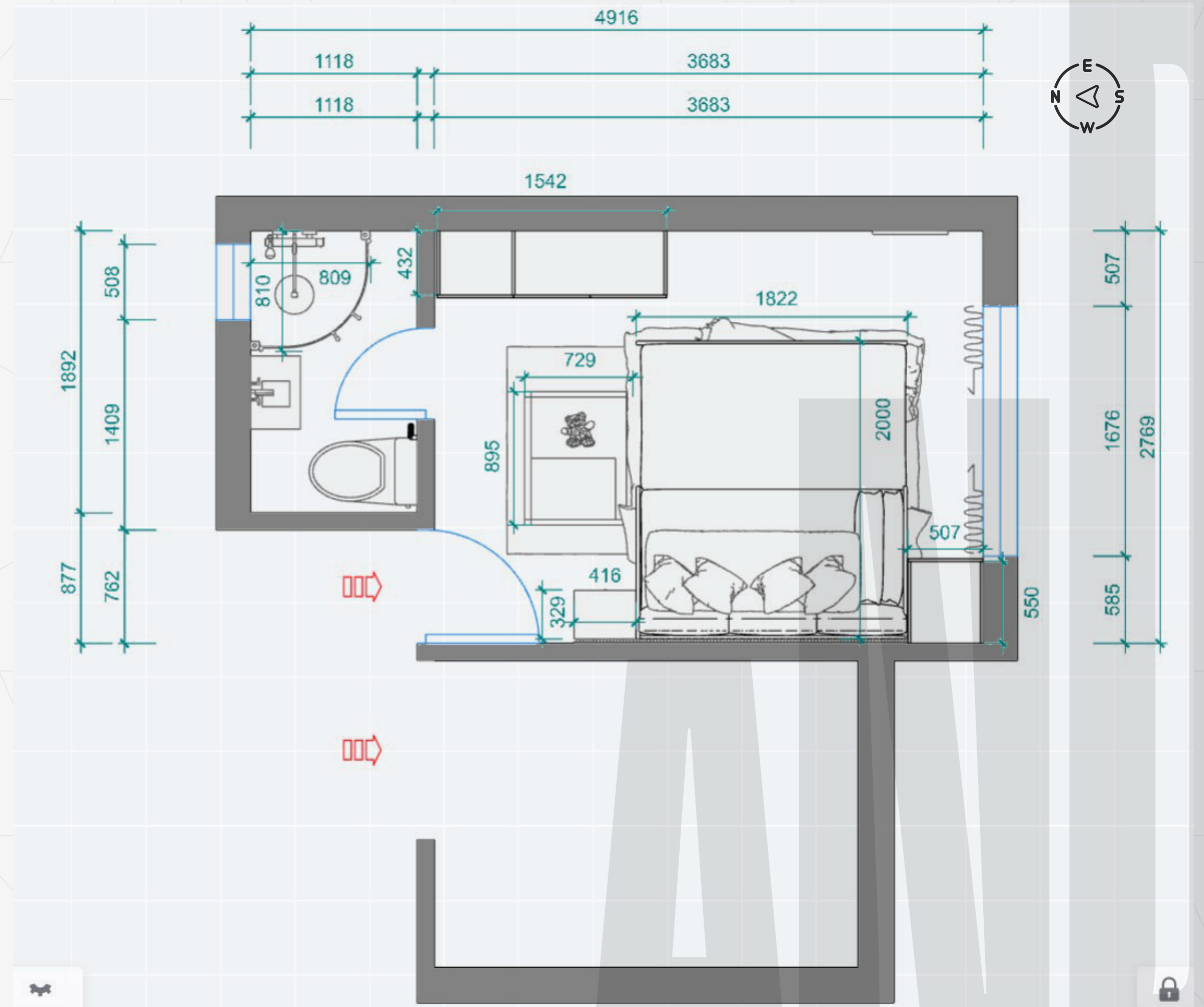

LAYOUT - 3

SWOT Analysis

Strength

- Adequate amount of negative space for circulation
- Privacy is maintained when the door is kept opened as the bed isn't visible from the living room
- Enough daylight.

Weakness

- Bedhead is on the wall with the half window which will be difficult for the client to hang their clothes for drying
- Only one side table can be included to allow more negative space to a room
- Insufficient wardrobe storage space

Opportunities

- Wall mount cabinet for additional storage

Threats

- Bedhead is on the wall with the half window which allows kids to throw anything from the window.

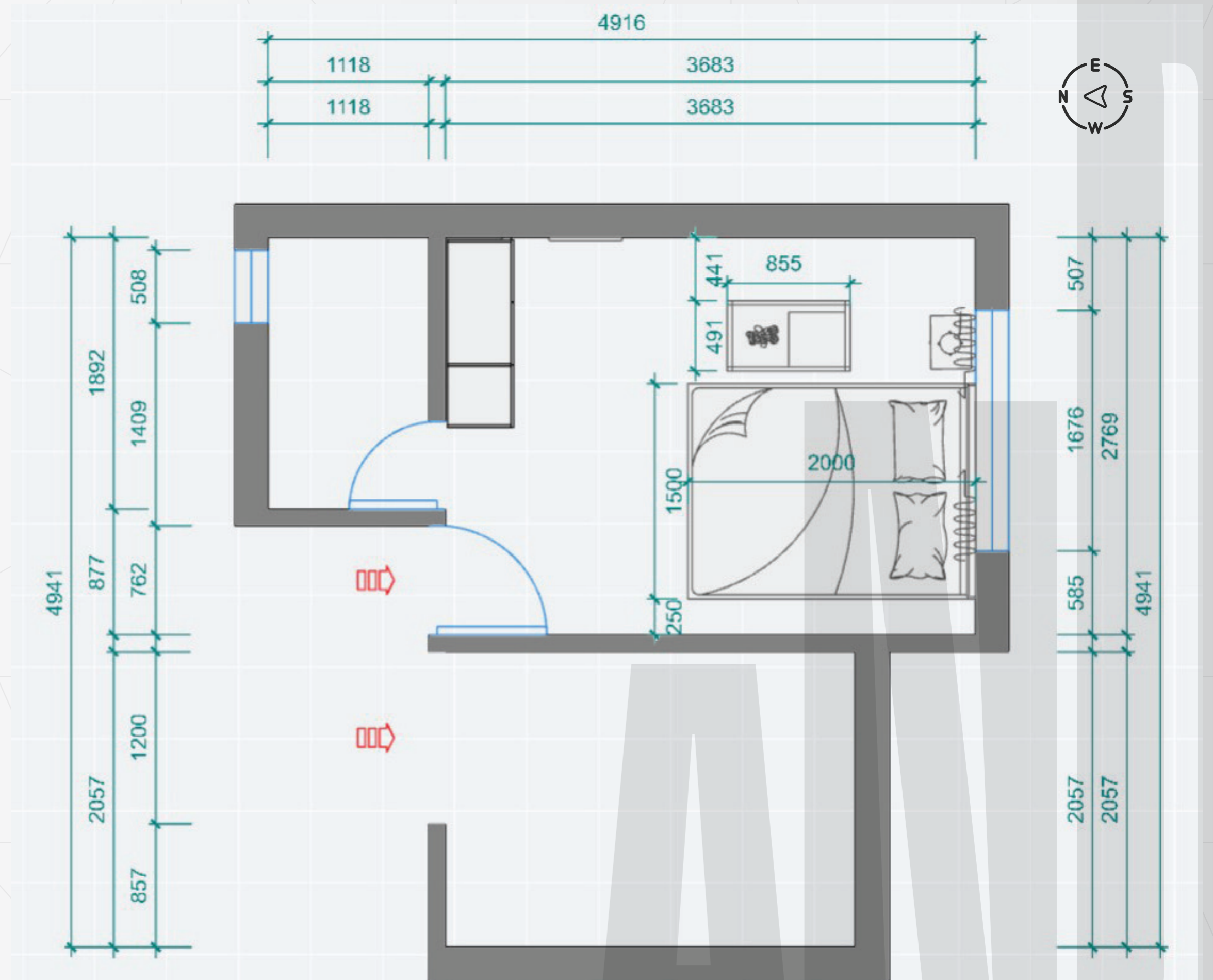

VAASTU LAYOUT

SWOT Analysis

Strength

- Adequate amount of negative space for circulation
- North East has 0% loading as per Vaastu

Weakness

- Privacy is lost when the door is kept opened as the bed is visible from the living room
- Minimum negative space for circulation when the sofa bed is extended
- Only one side table can be included to allow more negative space to a room
- Insufficient wardrobe storage space

Opportunities

- Sofa bed allows enough negative space for circulation & perform prayer

Threats

- It will be difficult for the person sleeping right side of the bed to go to bathroom at night.

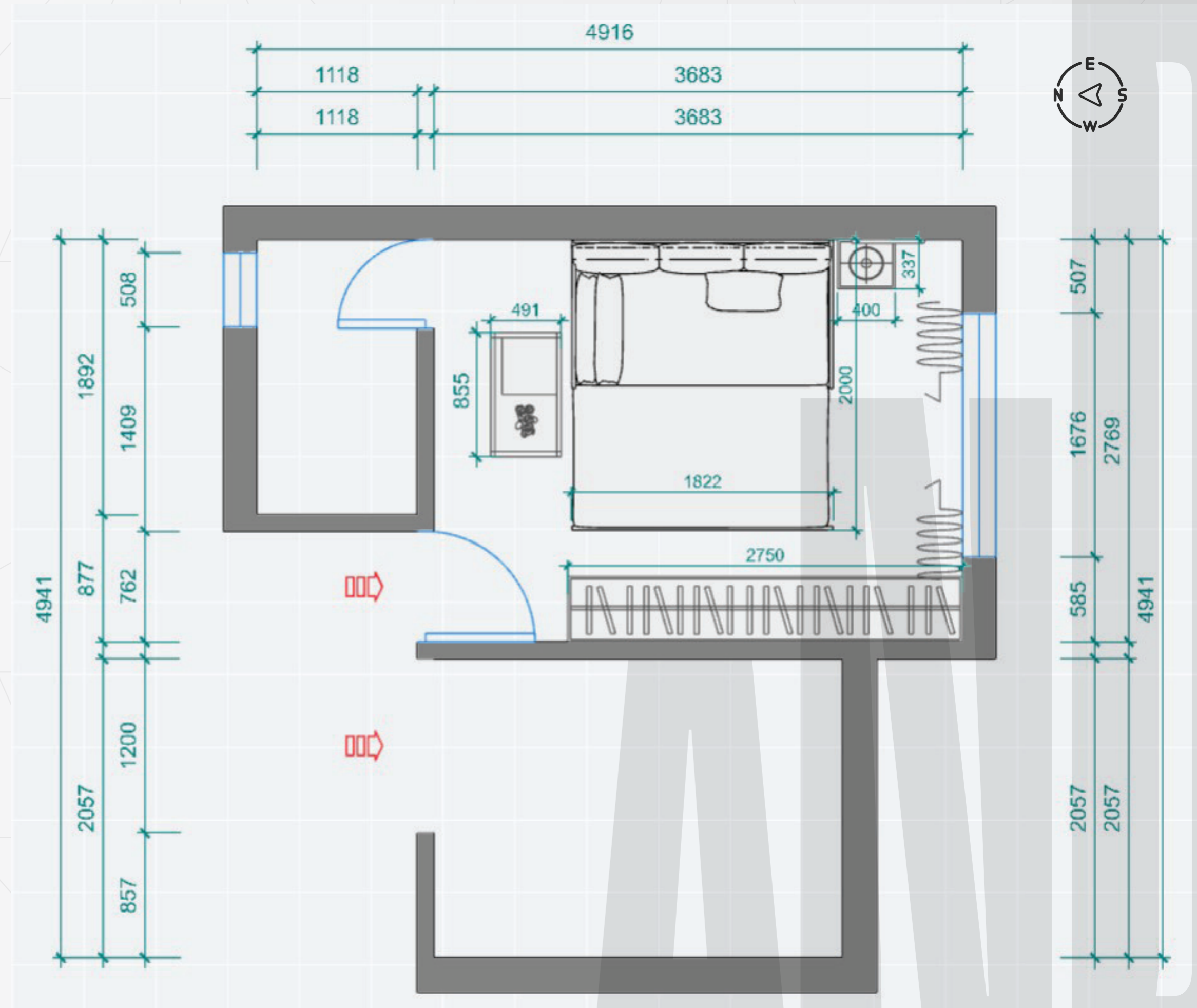

JAPANDI MOODBOARD

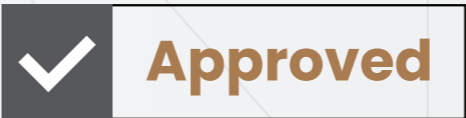

Color Palette

About Japandi Style

Japandi is heavily focused on simplicity, creating a peaceful and warm environment with a minimalist layout.

Bringing the best from two different sides of the globe – Scandinavia and Japan, to one calming fusion called Japandi or Scandi-Japanese style.

Wardrobe



Lamp



Baby cot

Curtains



Door



Wooden louvers

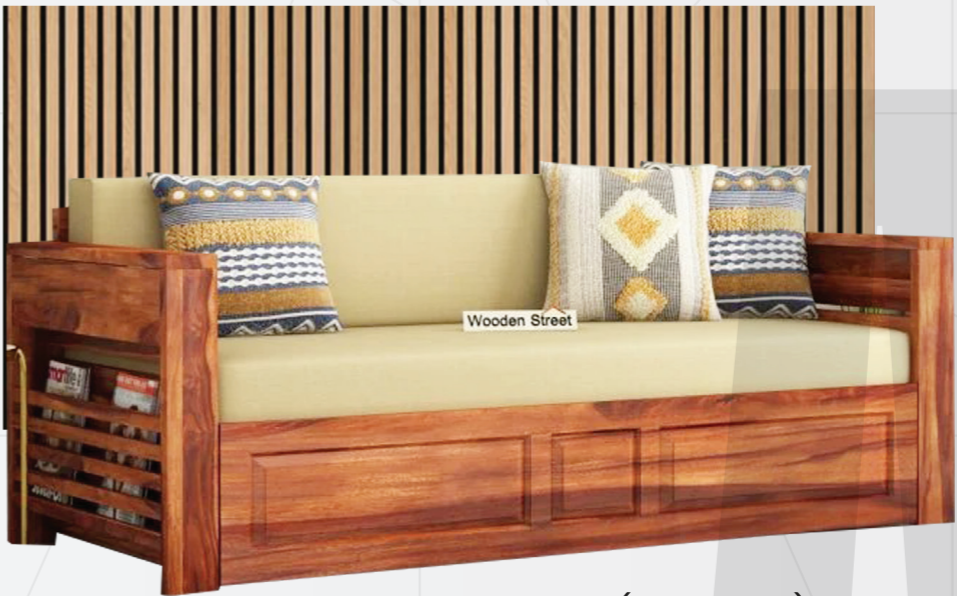

Sofa Bed (Closed)



Sofa Bed with storage (Open)

Side Table



Flooring



Design style of bathroom

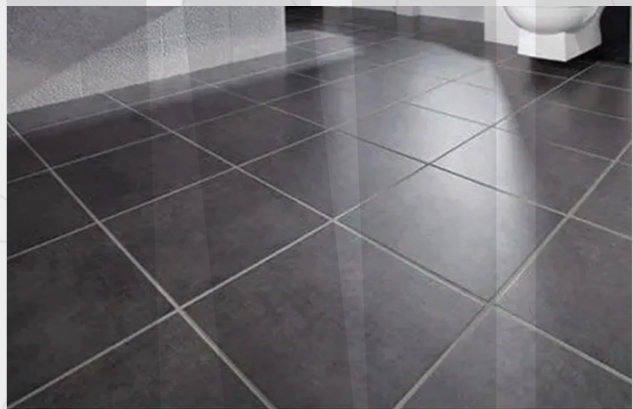

Bathroom Flooring

POP MOODBOARD

About Pop Style

Pop art in the interior has following characteristics:

- Bright, saturated, acidic and contrasting colors.
- There are posters, portraits of stars, comics. Images find their place not only on walls, but also on beds, household items, decor.

Wardrobe



Baby cot



Curtains



Cushions



Sofa Bed with storage (Open)



Side Table



Flooring



Color Palette



Design style of bathroom

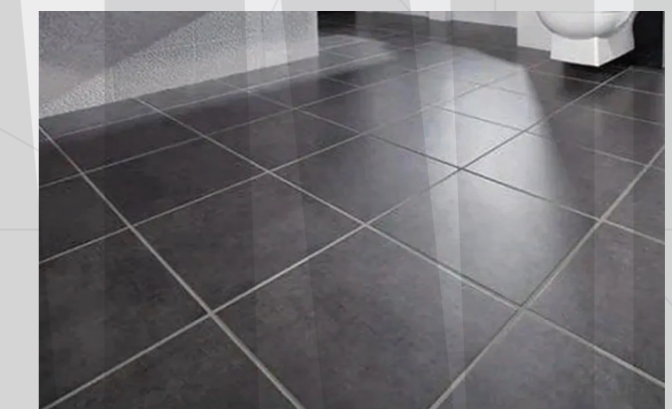

Bathroom Flooring

COLOR OPTION - 1

✓ Approved

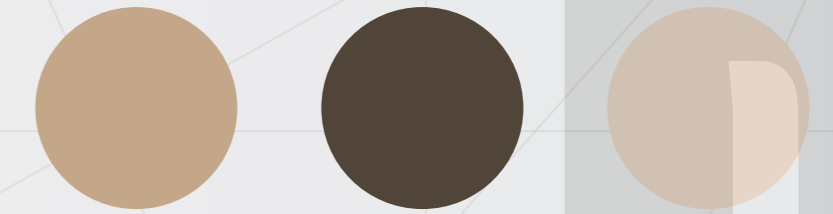

COLOR OPTION - 2

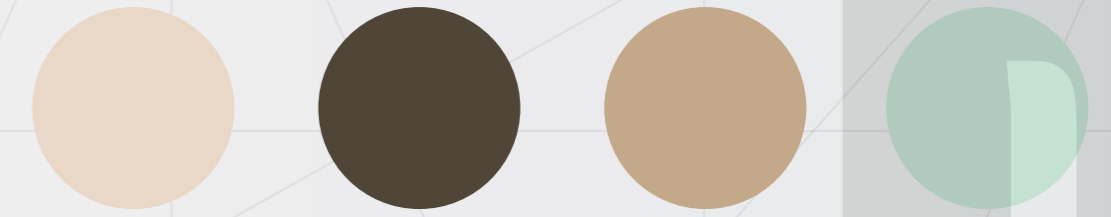

COLOR OPTION - 3

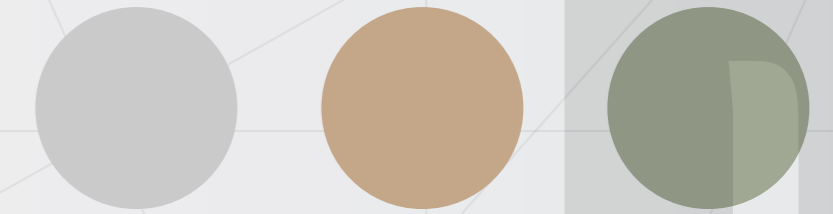

LIGHT OPTION - 1

✓ Approved



LIGHT OPTION - 2



MATERIALS & FINISHES OPTION - 1



→ Lamiate texture changed to Dark wood & Dark Grey

→ Curtains changed to blinds



→ Grey color Vitrified Tiles

→ Door textured changed to Dark wood

MATERIALS & FINISHES OPTION - 2



COOHOM

Laminate texture changed to Ivory Finish & Ashwood on single shutter

Curtains changed to cotton & lace material



COOHOM

Changed to Greige Wooden Tiles

Door textured changed to Ashwood

MATERIALS & FINISHES OPTION - 3



COOHOM

Shutter Laminate changed from Ashwood to Ivory Finish

Curtains changed to cotton & Voile material



COOHOM

Changed to Grey Wooden Tiles

Door textured changed to Brown Wood

MATERIALS & FINISHES OPTION - 1 & 2

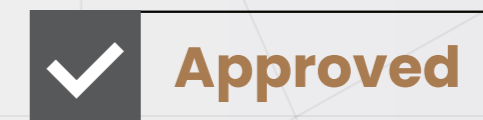

Grey color Vitrified Tiles from Option-1

FURNITURE & FURNISHING OPTION - 1

✓ Approved



Baby cot changed

Nightstand/Bed side table changed



Included additional furniture as a dresser to keep cosmetics products

FURNITURE & FURNISHING OPTION - 2



Baby cot changed

Nightstand/Bed side table changed



Dresser style changed

FURNITURE & FURNISHING OPTION - 3



Baby cot changed

Nightstand/Bed side table changed



Dresser style & placement changed



FINAL

RENDERERS



RENDERERS

Sofa Bed extended



RENDERERS

Sofa Bed Closed



RENDERERS

Bathroom

Size: Width 6'3" x 3'8"

Total Area: 23 sq.ft



Bedroom Elevation A(1:20)

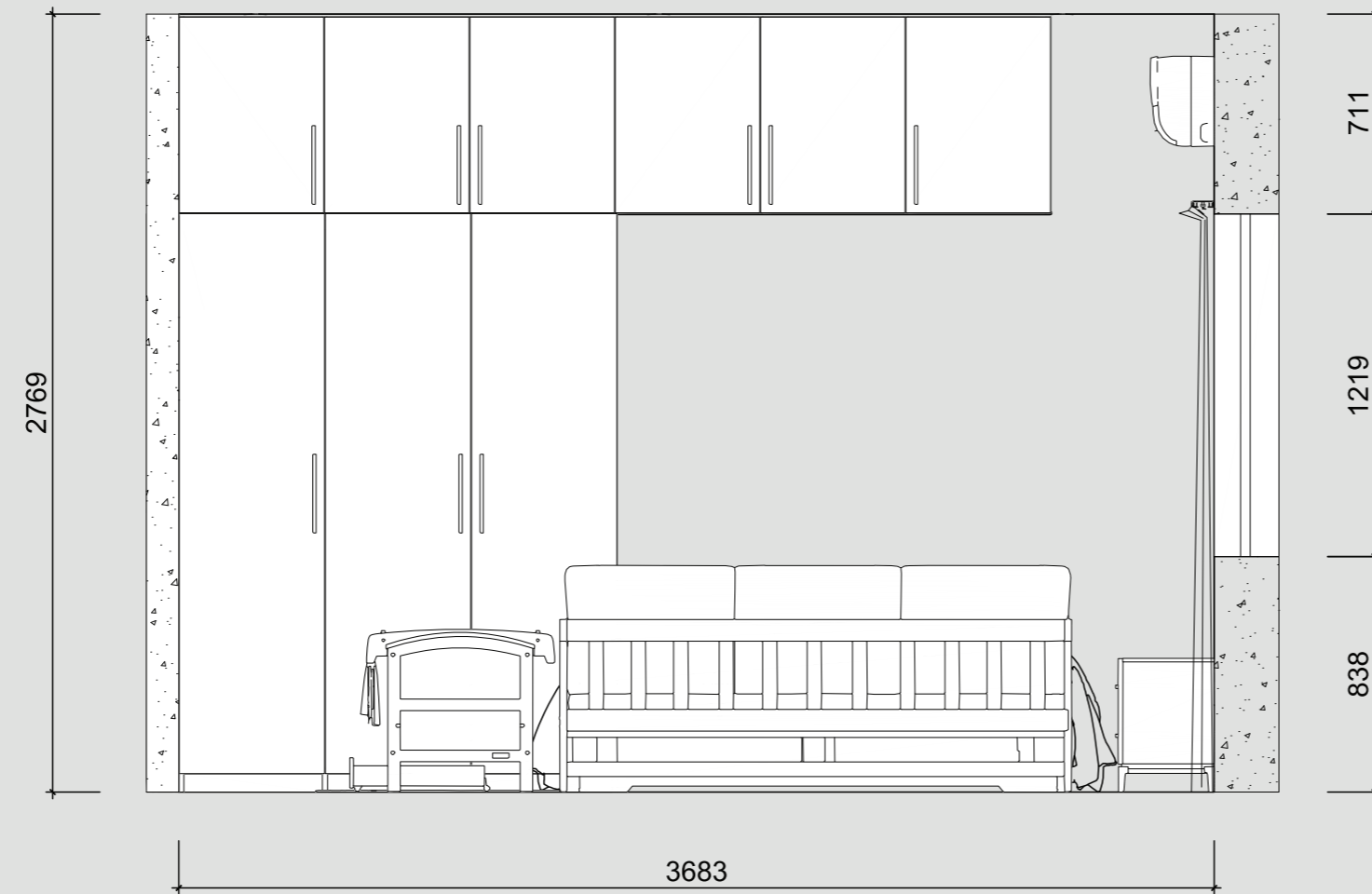

Bedroom Elevation B(1:20)

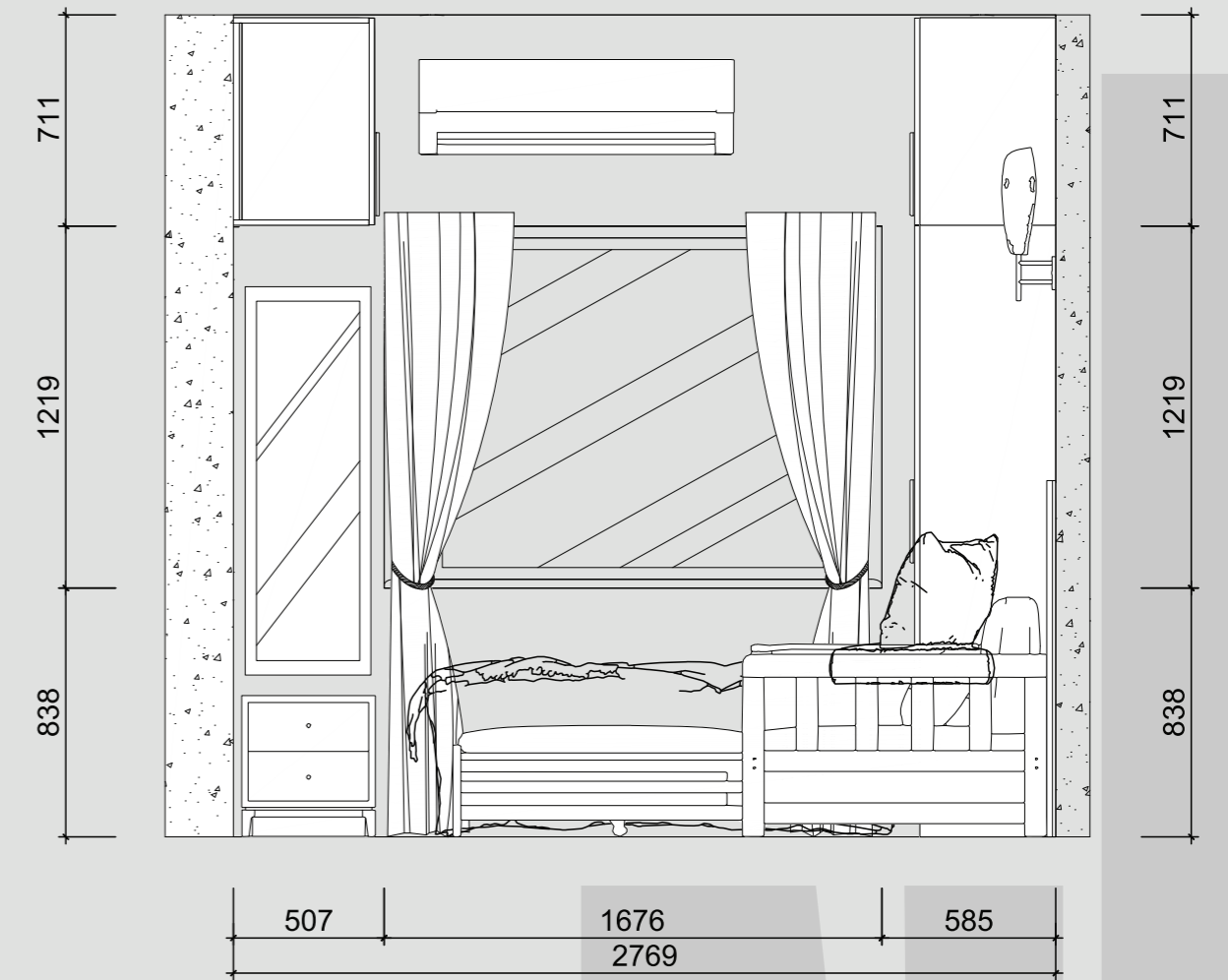

Bedroom Elevation C(1:20)

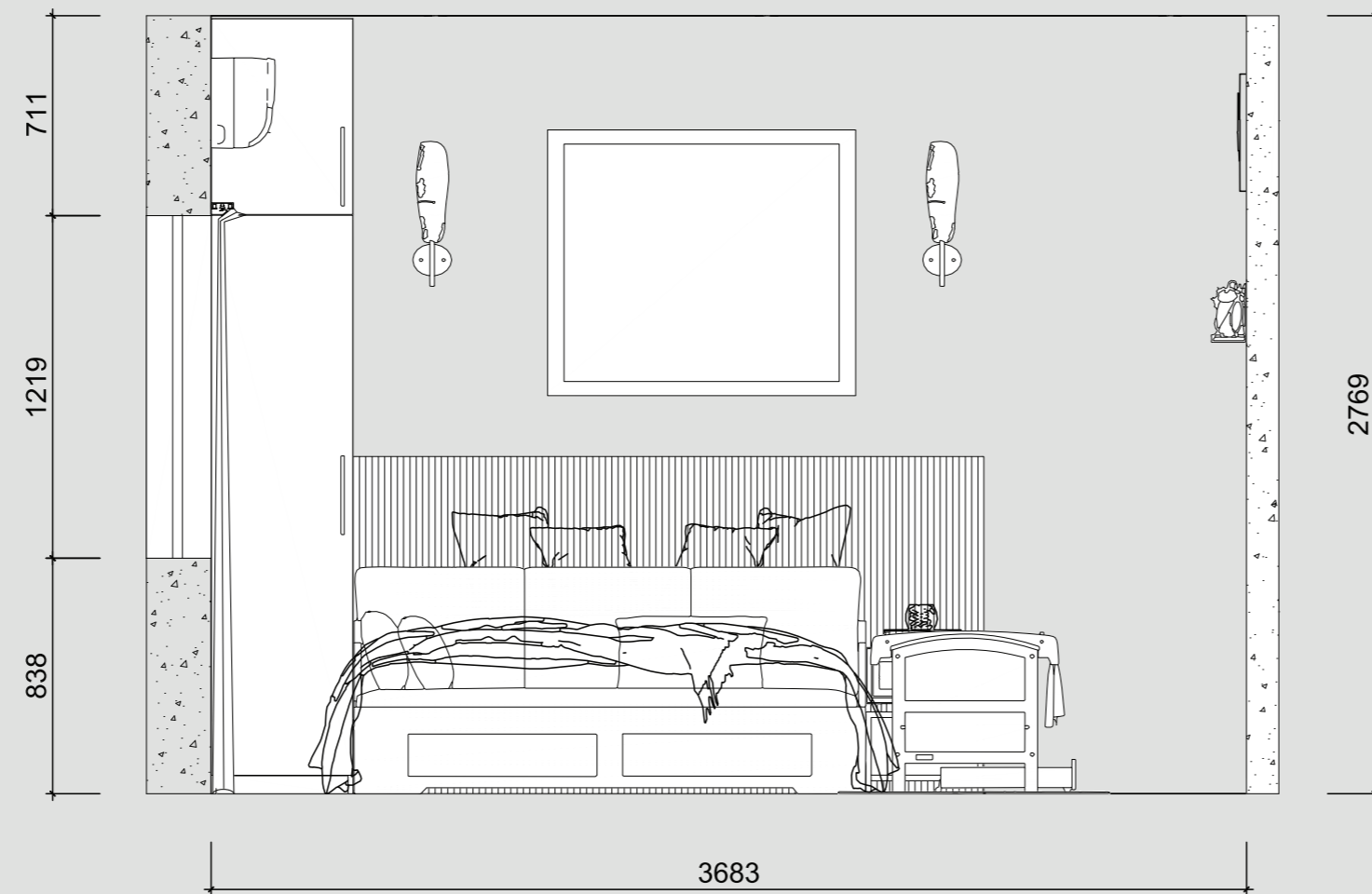



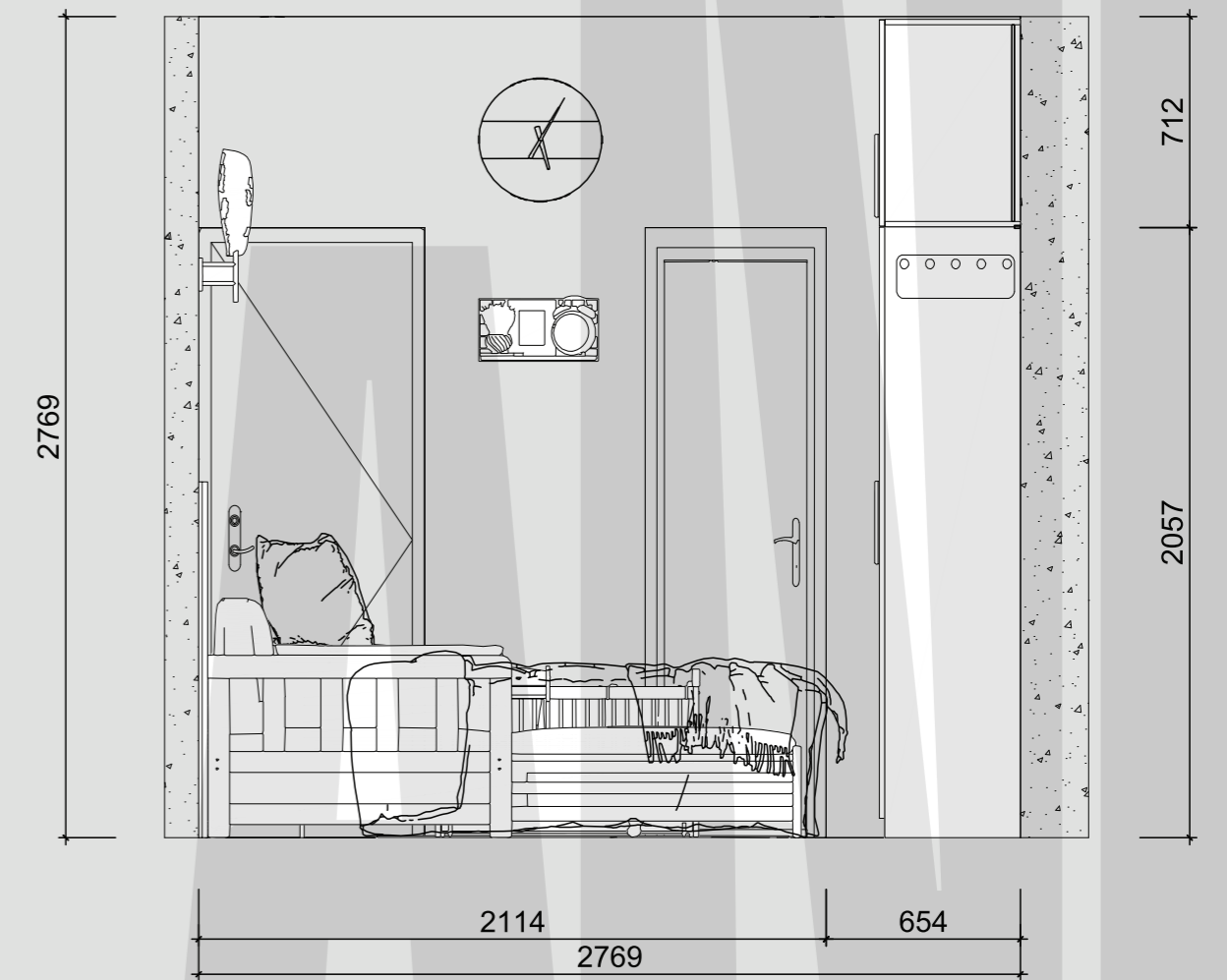

Bedroom Elevation D(1:20)

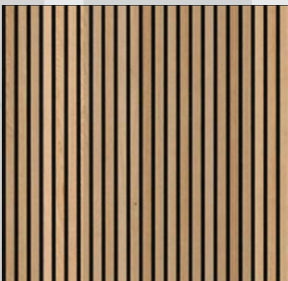

PROCUREMENT DATA

Description	Specification	Size	Color Code	Supplier	Image
Floor Tiles	Grey Color Kajaria Vitrified Tiles	800 x 800 mm	#9A9A9A	Pratik Tiles & Ceramics Add: Shop No. 9, Plot No.7, Gayatri Center, Sec -1, Nerul, Navi Mumbai	
Wall Paint	Asian paints (Moon Beam Beige)		0949	Spectrum Paints Add: Millennium Park Co-Operative Housing Society, Plot No.17, 22, 23, Sect- 25, Seswoods (E)	
Sofa Bed with Storage	MR Grade Plywood with Ashwood texture laminate	Open L 1822 x W 2000 x H 807 mm Closed L 1822 x W 1000 x H 807 mm	0949	Sujit (Carpenter) Contact No. 9821415770	
Custom Wardrobe	MR Grade Plywood with Ashwood texture laminate on one shutter & rest shutters of Ivory Finish laminate		0949	Sujit (Carpenter) Contact No. 9821415770	

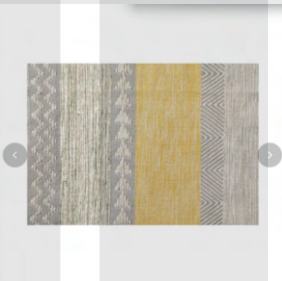
Description	Specification	Size	Color Code	Supplier	Image
Crib	Pinewood material	L 895 x W 527 x H 577 mm		https://hunyhuny.com/home/	
Wall Clock	Marble & Wood Wall Clock White & Beige			https://amala.earth/products	
Louvers/Fluted Panels	15mm thick Wooden fluted Panels	L 2244 x W 35 x H 1200 mm		Aakar Studio Add: 4/5, Plot No, Intop Arcade, Shop No, 2A opp. APMC Market, Phase, Sec-19D, Vashi, Navi Mumbai	
Side Table	Wooden Nightstand with Rattan Drawer			https://www.etsy.com/	
Ceiling Fan	Wooden Ceiling Fan	L 985 x W 985 x H 200 mm		The Fan Studio Add: Acespace, Next To Natuzzi Sofas, G.Floor, Raghuvanshi Mill, Senapati Bapat Road, Lower Parel	

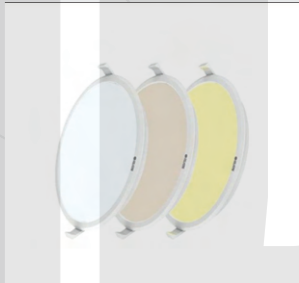
Description	Specification	Size	Color Code	Supplier	Image
Sconces/ Wall Lamp	Vintage Bamboo Sconce, Vintage Woven Wall Lamp	W 280 x H 250 mm		https://www.etsy.com/	
Full Length Mirror	Bamboo Large Mirror, Beige Color	W 450 x H 1200 mm		https://amala.earth/products	
Rug/Carpet	Pure Cotton Street Rug	W 700 x H 1400 mm		https://amala.earth/products	
Wall Mounted Shelf	Wooden and Metal Frame Shelf	L 403 x W 128 x H 221 mm		https://www.etsy.com/	
LED Panel Lights for Ceiling	Polycab 6 x 6W, 3-in-1 (Cool White, Natural White & Warm White) Color Changing LED Panel Light, Round			Lightique Concept Add: APMC Fruits and Vegetable Market, Sec-19, Vashi, Navi Mumbai	

CALLOUT IMAGE

Wall Paint

Asian paints
(Moon Beam Beige)
Color Code: 0949

Curtains

Cotton material
Green, Grey & White
Printed Color

Sofa Bed with Storage

MR Grade Plywood with
Ashwood texture laminate.
Mattress with cotton linen
& cushion upholstered.

Custom Wardrobe

MR Grade Plywood with Ashwood texture laminate
on one shutter & rest shutters of Ivory Finish laminate

Louvers/Fluted Panels

15mm thick Wooden
fluted Panels
Size: L 2244 x W 35 x H 1200 mm

Side Table

Wooden Nightstand
with Rattan Drawer (Handmade)

Floor Tiles

Grey Color Kajaria Vitrified Tiles
Size: 800 x 800 mm
Color Code: #9A9A9A

Rug

Pure Cotton Street Rug
Size: W 700 x H 1400 mm

Crib/Baby Cot with Storage

Pinewood material, Size: L 895 x W 527 x H 577 mm



CLIENT BRIEF DEVELOPMENT BOARD

Area	Requirements	Details/Options/Preferences	Actions Taken
Bedroom	<ul style="list-style-type: none">- Bed with Storage if possible- Closet/Wardrobe & Mirror- Side Table- Curtains/Drapes- AC/Fan- Ambient Light- Storage for kids clothes- Normal Tiles- Wall Arts- False ceiling- Baby cot if possible	<ul style="list-style-type: none">- Prefer Light Colors (Beige)- Bed with storage if possible- No working table- No television	<ul style="list-style-type: none">- Bed with storage (Delivered)- Wardrobe & Mirror (Delivered)- Side Table (Delivered)- Curtains (Delivered)- AC/Fan (Delivered)- Ambient Light (Delivered)- Storage for kids clothes- Normal Tiles (Delivered)- Wall Arts (Delivered)- False Ceiling (Delivered)- Baby Cot (Delivered)
	Refer Callout Sheet for Delivered Items		
Bathroom	<ul style="list-style-type: none">- WC (Dry Area)- Basin (Dry Area)- Shower Cabin (Wet Area)- Mirror- Storage- Clothes Hanger- Geyser- Lights- White marble tiles on the wall		<ul style="list-style-type: none">- WC with Dry Area (Delivered)- Basin (Delivered)- Shower Cabin (Delivered)- Mirror (Delivered)- Storage (Delivered)- Clothes Hanger (Delivered)- Geyser (Delivered)- Lights (Delivered)- White Marble Tiles on wall (Delivered)
	Refer Callout Sheet for Delivered Items		

THANK

YOU

AND